

THE CORPORATION OF DELTA ENGINEERING DEPARTMENT		DSN.	DRN.	DWG. No.
3 AVENUE CROSS SECTION COLLECTOR UNDIVIDED – 20m R/W		CHKD.	APV'D.	L 2.15
DATE	REVISION	SCALE	DATE	RVSN.
		N.T.S.	2015-05-03	
REVISIONS	No.	BY		

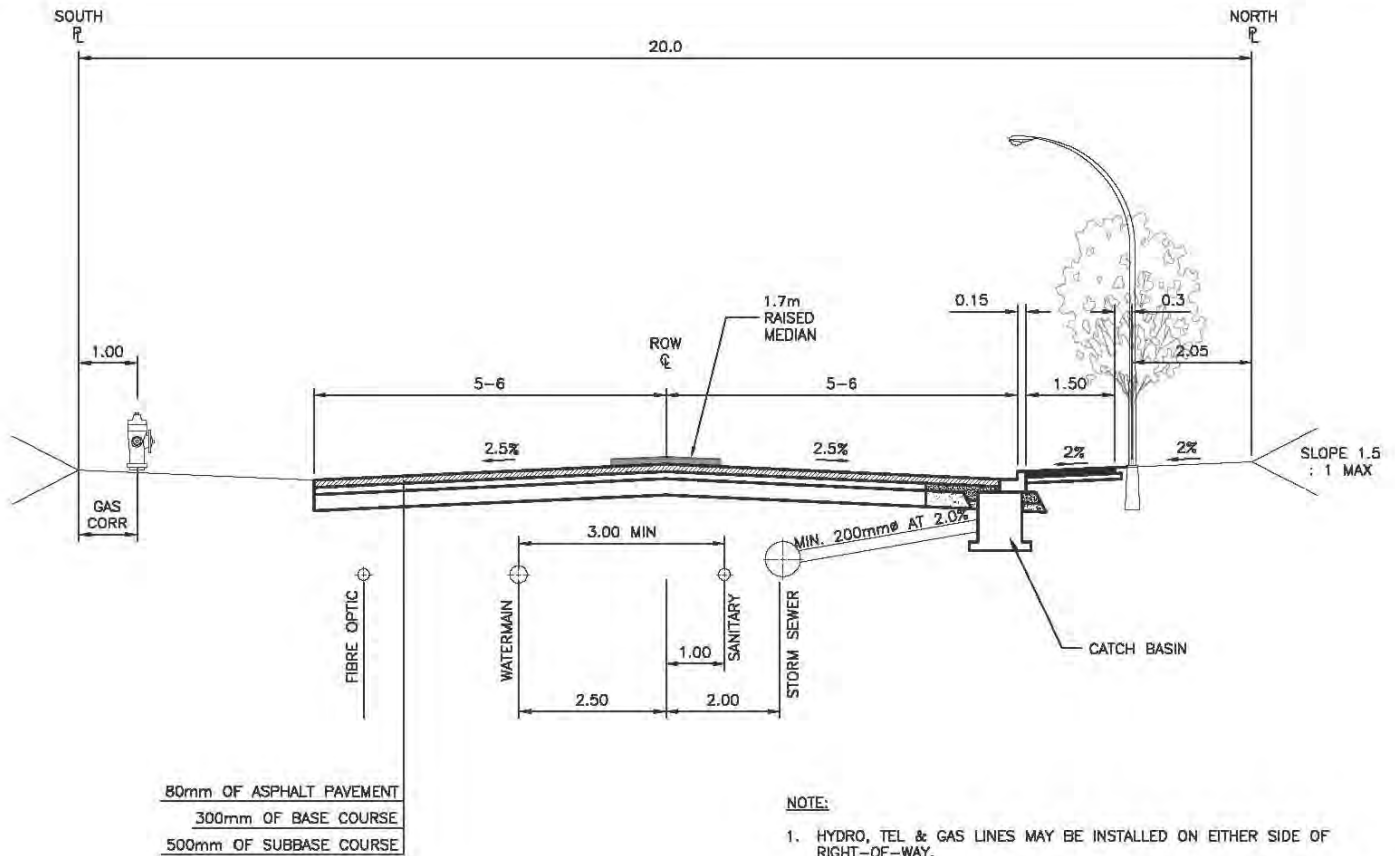

NOTE:

1. HYDRO, TEL & GAS LINES MAY BE INSTALLED ON EITHER SIDE OF RIGHT-OF-WAY.
2. UTILITY SERVICES SHALL BE INSTALLED PRIOR TO FINAL ROAD PAVING, OR MAINS SHALL BE INSTALLED ON BOTH SIDES OF RIGHT-OF-WAY. TRENCHES THROUGH NEW FINAL PAVEMENT FOR INSTALLATION OF MAINS OR SERVICE CONNECTIONS WILL NOT BE PERMITTED.
3. PAVEMENT SHALL BE LAID IN TWO LIFTS, INITIAL LIFT OF 40mm BY THE OWNER AND FINAL LIFT OF 40mm.
4. ROAD ALLOWANCE MUST BE SHAPED TO FULL WIDTH OF RIGHT-OF-WAY WITH CUT AND FILL SLOPES ON PRIVATE LAND.
5. THE DIRECTOR OF ENGINEERING MAY SPECIFY ALTERNATE SIDEWALK LOCATIONS.
6. SECOND STREELIGHT WHERE APPLICABLE.

NOTE:
 ALL DIMENSIONS SHOWN IN METRES
 UNLESS OTHERWISE NOTED.

3 AVENUE – 20m RIGHT-OF-WAY